

5678

9. EXPLODED VIEWS AND PARTS LIST

NOTES:

- Parts marked by “NSP” are generally unavailable because they are not in our Master Spare Parts List.
- The  mark found on some component parts indicates the importance of the safety factor of the part. Therefore, when replacing, be sure to use parts of identical designation.
- Screws adjacent to ▼ mark on product are used for disassembly.
- For the applying amount of lubricants or glue, follow the instructions in this manual. (In the case of no amount instructions, apply as you think it appropriate.)

9.1 PACKING SECTION

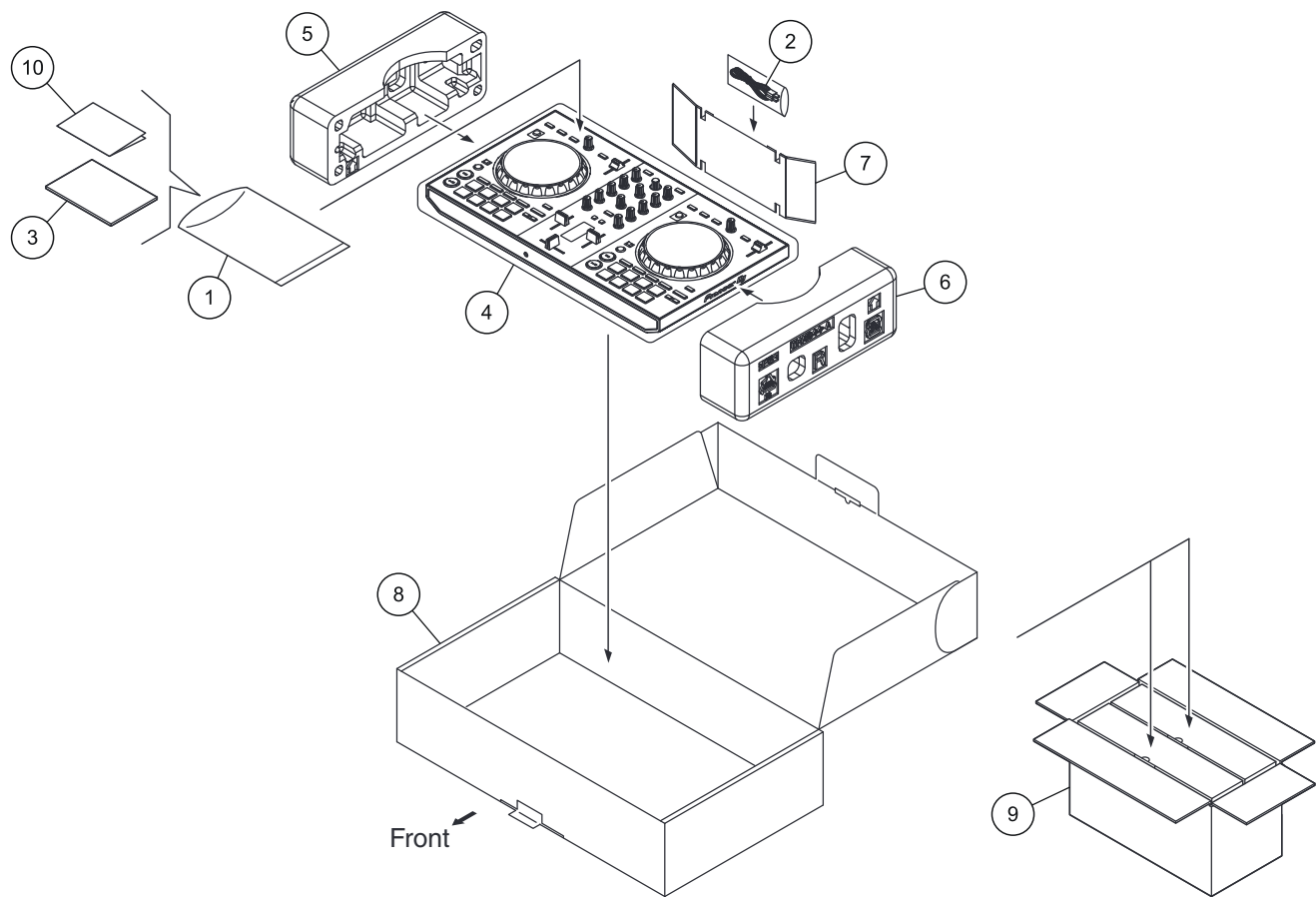

(1) PACKING SECTION PARTS LIST

Mark No.	Description	Part No.	Mark No.	Description	Part No.
NSP 1	Polyethylene Bag	AHG7117	6	Packing Pad	DHA1944
2	USB Cable	DDE1150	7	Partition/ACC	DHC1085
3	Operating Instructions (Quick Start Guide)	See Contrast table (2)	8	Packing Case	See Contrast table (2)
4	Packing Sheet	AHG7053	9	Master Carton	See Contrast table (2)
5	Packing Pad	DHA1943	NSP 10	Warranty	See Contrast table (2)

(2) CONTRAST TABLE

SXJ and XJCN are constructed the same except for the following:

Mark	No.	Symbol and Description	SXJ	XJCN
	3	Operating Instructions (Quick Start Guide)	DRH1498	DRH1499
	8	Packing Case	DHG3622	DHG3623
	9	Master Carton	DHG3625	DHG3626
NSP	10	Warranty	DRY1270	Not used

[illegible]

• Bottom view

Exploded view diagram of the bottom view of a device, showing various components and their assembly sequence. The diagram includes parts numbered 1 through 50, with some parts having fractional quantities (e.g., 1/2, 1/3, 2/2, 2/3). Key components labeled include 'Asetate Tape 25 x 40 mm' and 'Asetate Tape 10 x 65 mm'. The diagram is divided into sections A, B, C, D, E, and F, indicating different assembly stages or areas. The bottom view shows the internal structure, including two large circular fans (34, 35) and various mounting brackets and screws.

- For details of Grease application, refer to **“7. DISASSEMBLY [4-1] Procedure for applying grease during reassembly of the Jog Dial”**.
- For details of Acetate Tape paste, refer to **“1.3 SERVICE NOTICE ■ Paste Acetate Tape on the back face of PCB”**.
- For splitting buttons, refer to **“7. DISASSEMBLY [2] Notes on Replacing Buttons”**.
- If product rattles, refer to **“1.3 SERVICE NOTICE ■ How to modify when rattling of product is occurred”**.
- For details of No. 50 Spacer paste, refer to **“7. DISASSEMBLY [4-5] About correspondence for Performance Pad and Mode Button click feeling improvement”**.

(1) EXTERIOR SECTION PARTS LIST

Mark No.	Description	Part No.	Mark No.	Description	Part No.	
1	MAIN ASSY	DWX4132	26	Button	DAC3375	
2	DCK1 ASSY	DWX4133	27	Button	DAC3151	A
3	HPJK ASSY	DWX4135	28	Button	DAC3376	
4	HLD1 ASSY	DWX4136	29	Button	DAC3350	
5	HLD2 ASSY	DWX4137	30	Button	DAC3221	
6	PNL2 ASSY	DWX4134	31	Panel	DAH3204	
7	FFC	DDD1771	32	Button	DEB2064	■
8	FFC	DDD1851	33	•••••		
9	FFC	DDD1852	34	Control Panel	DNK6759	
10	Rubber Foot	VEB1349	35	Chassis	DNK6760	
11	Plate	DAH3205	36	Knob	DNK6530	B
12	Gasket/JOG	DEC3539	37	Sheet	DEC3795	
13	DS Tape/JOG	DEH1042	38	Plate/CND	DNH3137	
14	Jog Dial	DNK6768	39	Stay	DNH3352	
15	Dial Knob S(B)	DAA1273	40	Plate	DNH3353	■
16	Knob/PLS	DAA1324	41	Screw	ASZ26P050FTC	
17	Slider Knob 1	DAC2684	42	Screw	BPZ30P100FTC	
18	Slider Knob 2	DAC2685	43	Screw	BPZ30P120FTB	
19	Stopper/SLD	DNK6009	44	Screw	BPZ30P080FTB	
20	Button/FX	DAC2796	45	Screw (M3 x 5)	DBA1340	C
21	Button	DAC3373	46	Nut (M12)	NKX2FNI	
22	Button	DAC3379	47	Washer	WA62D095D050	
23	Button	DAC3230	48	Washer	YC60FAC	
24	Button/OPL	DAC2952	NSP 49	Name Label	See Contrast table (2)	
25	Button	DAC3098	50	Spacer	DEC3808	■
* Cross fader part and deck 2 side tempo slider part are connected with parallel jumper wires, but the service parts are not supplied as board ASSY. Please correspond by parts replacement. If you can not respond by replacing parts, order DCK 1 ASSY, PNL 2 ASSY.						

(2) CONTRAST TABLE

SXJ and XJCN are constructed the same except for the following:

Mark	No.	Symbol and Description	SXJ	XJCN
NSP	49	Name Label	Not used	DRW2765